



**DATE:** June 27, 2022

**MEMO TO:** Terry Wilke, Chair  
Planning Committee

**FROM:** Randall L. Seebach  
Director of Planning and Land Preservation

**REQUEST:** Provide Policy Direction regarding a potential agreement with the Village of Lake Barrington to provide a trail connection and crosswalk at Grassy Lake Forest Preserve.

**STRATEGIC DIRECTIONS SUPPORTED:** Public Access and Connections, Leadership, Organizational Sustainability

**FINANCIAL DATA:** The materials, labor and permitting cost for this project is estimated at \$71,350.00. The District's share of the cost would be determined through negotiations with the Village of Lake Barrington.

**BACKGROUND:** The District currently has an existing maintenance access from Miller Road to the existing trail at Grassy Lake Forest Preserve located on the south side of Miller Road. The existing access is located approximately 340 feet east of Wedgewood Lane, which is the entrance to Wedgewood Trails subdivision, located on the north side of Miller Road. The District and the Lake County Division of Transportation (LCDOT) recently received requests from two residents and the Village of Lake Barrington (Village) to consider providing a safer pedestrian access from the Wedgewood Trails subdivision to Grassy Lake Forest Preserve. Currently, residents must walk within the Miller Road right of way to the maintenance access. In addition, the existing site lines at the maintenance access are not ideal and present a challenge for District staff to enter and exit.

District staff, LCDOT and the Village have had preliminary discussions regarding the opportunity for providing a safer pedestrian access for local residents, including the potential relocation of the existing maintenance access to the intersection of Miller Road and Wedgewood Lane where there are improved sight lines and a better opportunity for a painted crosswalk.

Staff is looking for direction whether to continue discussions and/or negotiate an intergovernmental agreement with the Village that would identify the relative obligations and rights of the District and the Village related to the design, construction, maintenance and replacement of the potential trail and crosswalk improvements. That agreement would be presented to the Planning Committee for review and recommendation at a later date.

**REVIEW BY OTHERS:** Executive Director, Chief Operations Officer, Director of Finance, Corporate Counsel.





Lake County  
Forest Preserves

### Grassy Lake Miller Road Access

#### LEGEND

	Manhole	CL	DEPTH OF FILL
	Pipe End	774	1
	Storm Sewer Pipe	775	1
	Index	776	1
	Intermediate	777	1
	Forest Preserve Boundaries	778	2
	Roads	779	3.5
	Tree	780	3.5
	Planning Line	781	3
	Grassy Lake Spot Elevations	782	2
		783	2
		784	1

25/11 = 2.3' AVG DEPTH  
 2.3 x 24' WIDE = 55.2 x 350  
 = 19,320 CF  
 = 715 CY TOTAL FILL

3.1% LONGITUDINAL CL SLOPE  
 784.84 TO 774.04 = 10.8 Δ OVER 350'

10' WIDE TRAIL  
 3' WIDE SHOULDERS @ 5%  
 3:1 SIDE SLOPES

- 40' AVERAGE DISTURBANCE ALONG 350' OF TRAIL
- 10' IS AGGREGATE SURFACE x 350 = 3500 SF
  - 4" ASK BASE x 350 = 1400 SF
  - 16" BITUMEN (PAVED?) x 350 = 5600 SF
  - 2" SAND & NATIVE x 350 = 700 SF
  - 11' AGG. BASE x 350 = 3850 SF = 428 SF
  - 5" THICK = 1,604 SF = 59 CY
  - 6' SHOULDERS x 350 = 2100 SF = 233 SF
  - 24' NATIVE MIX x 350 = 8400 SF = 933 SF

715 CY TOTAL FILL  
 - 59 CY BASE  
 - 32 CY SURFACE

624 CY FILL IMPORT

MAINT. ACCESS ROAD 170' x 20' W x 1' DEPT = 3400 CF  
 - 3400 SF = 378 SF OF NATIVE MIX = 126 CY

ADDITIONAL ON-SITE SOIL MOVEMENT

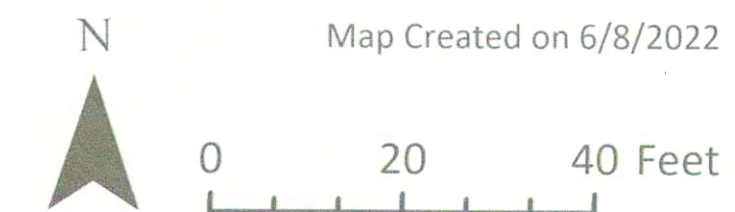

Map Created on 6/8/2022  
 Disclaimer: Property Boundaries and other data provided is for general information only and not for commercial purposes. The District provides this data for the user's exclusive use only. Any re-use, transmission, duplication, or distribution without the permission of the District is prohibited. Map sources include: Lake County GIS Division | Basemap: 2021 Aerial

