



Lend a hand!

Come on **down** to the **farm** and lend a hand. There's plenty of fun and learning to go 'round!

Garden Volunteers help with plantings and maintain the flower, herb and vegetable gardens, **Exhibit Volunteers** help clean and maintain the exhibits, and **Program Volunteers** help with public and school programs.



Learning is fun!

Discover the **fundamentals** of learning with Bonner Heritage Farm's educational programs for **school field trips** and **summer camp programs**. Investigate topics such as dairy cows, barnyard animals, field crops, weather, and more. **Call 847-968-3400.**

Getting here

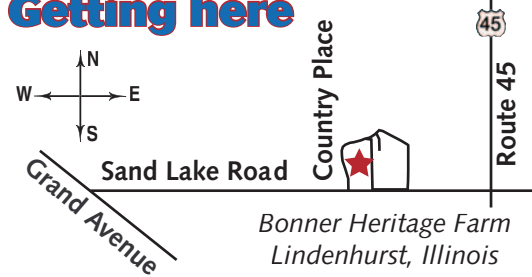

Enter on Country Place, off of Sand Lake Road, west of Route 45. Farm and self-guided exhibits open daily, 6:30 a.m. to dusk.

Restrooms and water are located at Lindenhurst Park District's adjacent Millennium Park.

Let's Celebrate!

Everyone loves a party! Celebrate with larger-than-life fun and specially-themed children's parties. Seasonal availability.

For information on volunteer opportunities, or to reserve your party, call 847-968-3400, or visit online at www.LCFPD.org.



The fun starts here!

Bonner Heritage Farm



Learn the story of farming in Lake County through self-guided, larger-than-life exhibits!



Welcome to the Farm!

Visit Bonner Heritage Farm, the Lake County Forest Preserves' self-guided, interactive farm experience!

Building a History

The **Bonner Heritage Farm** is full of history. Its buildings and exhibits bring to life a unique picture of farming and agriculture in Lake County.

It all began with Scottish immigrants William and Margaret Bonner, who settled on the site in 1848, and built two farmhouses (map: "Meet the Bonners"). As was common in farming communities, consecutive generations of Bonners worked the land. The west house, where William's family lived, still stands today (map: "West House").

The most historically significant building on the site is the main "great" barn. The original oak-and-hickory barn was small and held just five cows. Built in 1848, this portion of the main barn is among the oldest surviving intact great barns in Lake County. As the family grew, the barn also expanded with five additions and two silos.

The farm also includes a carpenter's shop built around 1850, a granary, hay barn, pump house, hog house, chicken coop, and storage shed. The smallest structure on the site is the 19th-century outhouse (map: "Outhouse Exhibit"). In 1995, Howard "Shorty" Bonner, the Bonners' great-grandson, donated this eight-acre cluster of buildings to the Forest Preserves for all to enjoy.

A-Maze-ing Fun

At the farm, "hands-on" play is the best way to learn. Beginning in the maze exhibit, visitors explore a quilted grid of interactive activities (map: "Maze"). The windmill and weather station (map: "Windmill") provide a colorful look at the important role weather plays in farming. Larger-than-life exhibits dot the heritage trail, including plays in farming. The farm also connects to the Forest Preserves' **Millennium Trail**, for a scenic hike or bike ride to nearby **McDonald Woods Forest Preserve**.

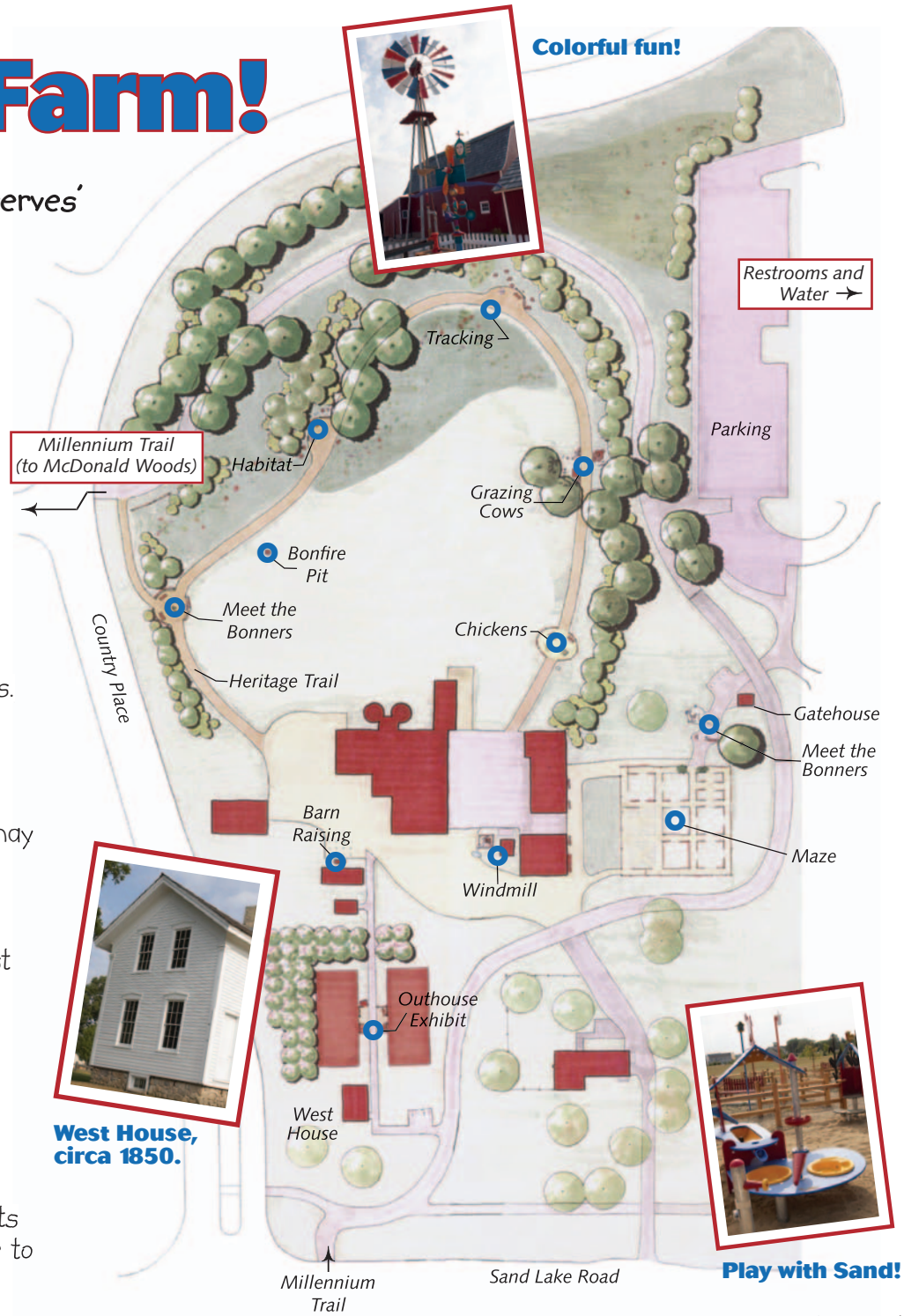

Colorful fun!



West House, circa 1850.



Play with Sand!